

# **Givins/Shaw Jr PS Review**

## **Public Meeting**

May 8, 2018



# Agenda

6:30 p.m. to 8:30 p.m.

1.	6:30 to 6:50 - Open House
2.	6:50 to 7:15 Presentation <ul style="list-style-type: none"><li>• Setting the Context - Why are we here?</li><li>• Program Area Review Process</li><li>• Background Information, Enrolment Projections and Space Requirements</li><li>• PART Preferred Option</li><li>• Next Steps</li></ul>
3.	7:15 to 8:30 – Questions and Answers

# Setting the Context – why are we here?

- The study was first identified in the Long-Term Program and Accommodation Strategy document in 2014
- Previous PART process (Spring 2016) resulted in a Board Decision, June 22, 2016:  
“(b) That Givins/Shaw Junior Public School be reconfigured from a Junior Kindergarten to Grade 6 school to a Junior Kindergarten to Grade 5 school effective 1 September 2017 and that Grade 6 students from Givins/Shaw Junior Public School to go to Alexander Muir/Gladstone Avenue Junior and Senior Public School through to Grade 8 effective 1 September 2017.”
- The following study is the focus of this Program Area Review Team (PART) exercise:
  - Explore a review of the grade change at Givins-Shaw Jr. PS approved in June 2016 for implementation in September 2017, to determine if the transition from a JK-6 to a JK-5 is the most appropriate accommodation solution for this school at this time. **The implementation of the grade change will be deferred until this study is completed in the fall of 2017.**

# TDSB Long-Term Program and Accommodation Strategy

## Program Drivers

- Program choice
- Equity
- Fair access to specialized program and schools
- Viability

## Accommodation Drivers

- Good distribution of schools
- Minimal transitions
- Minimal use of portables
- Service integration
- Good utilization
- Distinct attendance areas
- Efficient use of space

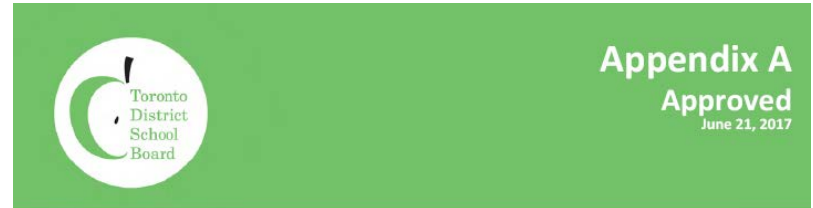

## Long-Term Program and Accommodation Strategy 2017-2026



Find What Inspires You

V3

## Program Area Review Process (PART)

**Central Accommodation Team (CAT) Project Launch**  
Studies in the LTPAS are approved by CAT to commence Local Feasibility Team work  
September 2017

**Staff Review Process**  
Local Feasibility Team (LFT)  
Trustees, Superintendent, Principals and Planning Staff  
October 2017 to April 2018

**Public Review Process**  
Program Area Review Team (PART)  
Trustees, Superintendent, Principals, School Representative, Design and Planning Staff Meetings and a Public Meeting  
April to May 2018

**TDSB Final Approval Process**  
Trustees, Superintendent and Executive Staff  
Report considered by Central Accommodation Team  
Report considered by Planning and Priorities – June 13, 2018  
Report considered by Board – June 20, 2018

Step 1



Step 2



Step 3  
(We are here)



Step 4

# Program Area Review Team Membership

School/Organization	Name	Position
<b>Givins/Shaw Junior Public School</b>	Dan Taylor Dale McIntosh Kim MacFarlane Myfanwy Marshall	Principal Parent Representative Parent Representative Parent Representative
<b>Learning Centre 4, Learning Network 25</b>	Mike Gallagher	Superintendent
<b>TDSB Ward 10</b>	Ausma Malik	Trustee

# Givins/Shaw Jr PS – Public Meeting

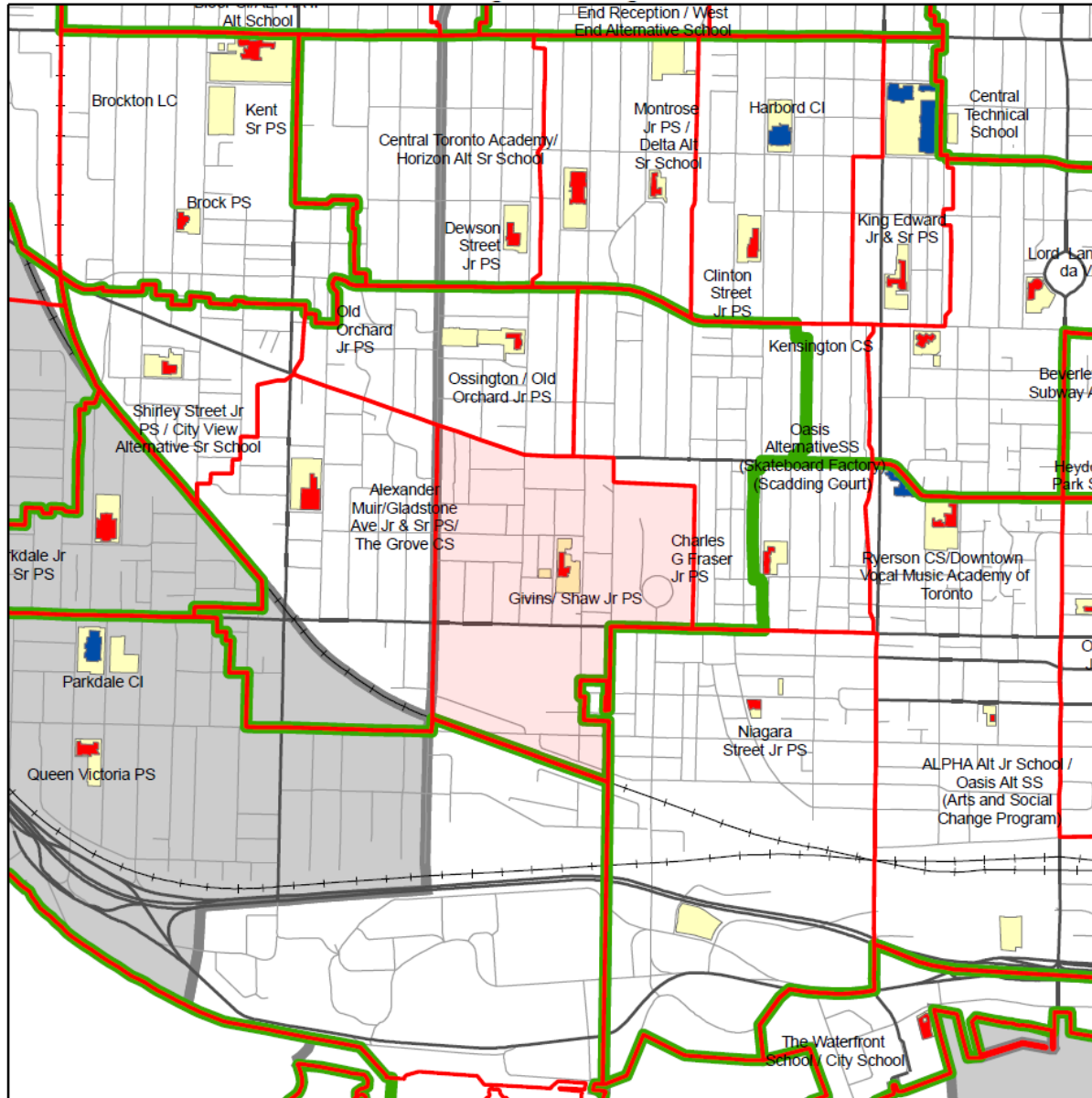

## Legend:

- Junior Attendance Area
- Intermediate Attendance Area
- School Site
- Parks
- Elementary School
- Secondary School
- Road

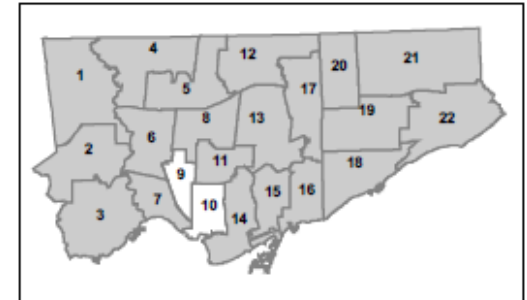

**Please note:**  
The lines on this map representing the Attendance Areas are approximate. For specific information on designated schools to serve individual addresses, please consult the TDSB Street Guide.

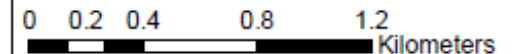

Produced by:  
Planning Division, TDSB  
March 2018  
Source:  
Base Map- Geospatial Competency Centre  
Facility - Planning Division, TDSB  
Data- City of Toronto



# Projecting Enrolment for Individual Schools

## Population

- Primarily births to 4 year olds as an indicator for projecting Junior Kindergarten

## Transitions & Programs

- French – SK Immersion, Grade 4 and Grade 7 Extended
- Alternative Schools and Specialized Programs

## Residential Development

- Currently for Givins/Shaw Jr PS there are 3 Active Developments, totalling 251 condominium units



# Current Situation – Givins/Shaw Jr PS

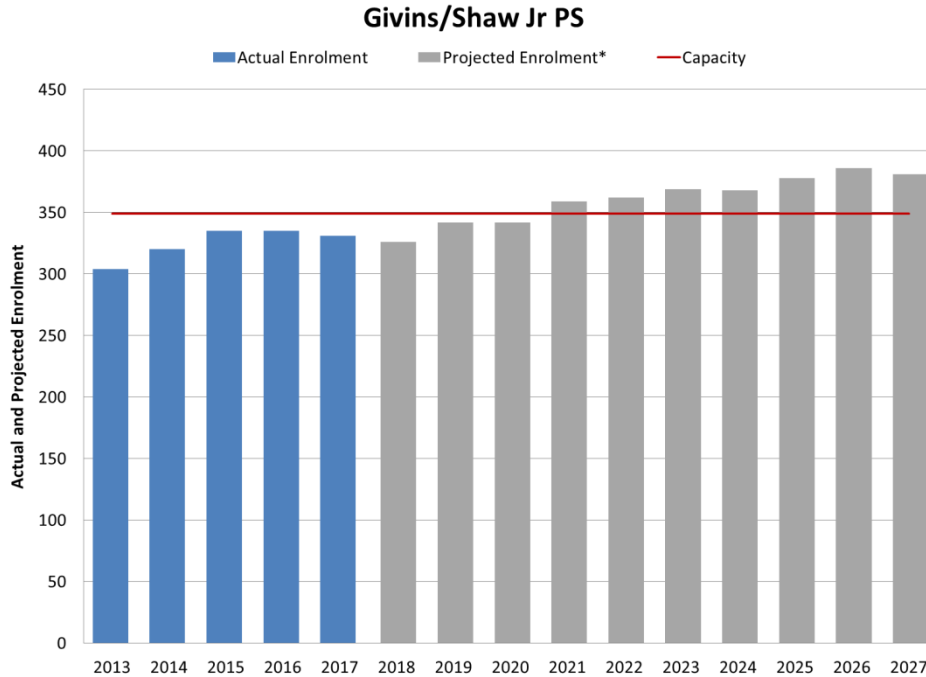

**Givins/Shaw Jr PS**  
 JK-Grade 6 (deferred grade range change)

**Site Size:** 3.42 acres

**Current School Capacity:** 349

**2017/18 Enrolment (Oct 31<sup>st</sup>):** 331

**Current Building Utilization:** 95%

**2017/18 Optional Attendance Status:** Closed

**Existing Permanent Classroom Spaces:** 17

	2018	2019	2020	2021	2022	2023	2024	2025	2026	2027
Enrolment	326	342	342	359	362	369	368	378	386	381
Utilization	93%	98%	98%	103%	104%	106%	105%	108%	111%	109%
Classroom Surplus/ Deficit	0	-1	-1	-2	-2	-2	-2	-2	-2	-2

# Givins/Shaw Jr PS

## With Grade 6 (PART recommendation)

	2018	2019	2020	2021	2022	2023	2024	2025	2026	2027
Enrolment	326	342	342	359	362	369	368	378	386	381
Utilization	93%	98%	98%	103%	104%	106%	105%	108%	111%	109%
Classroom Deficit	0	-1	-1	-2	-2	-2	-2	-2	-2	-2

## Without Grade 6

	2018	2019	2020	2021	2022	2023	2024	2025	2026	2027
Enrolment	326	298	313	315	324	322	332	341	336	338
Utilization	93%	85%	90%	90%	93%	92%	95%	98%	96%	97%
Classroom Deficit	0	0	0	0	0	-1	0	-1	0	0

# Capacity and Instructional Space

Room Type	Ministry Rated Capacity (Pupil Places)		# of rooms at Givins/Shaw Jr PS		Capacity
Classrooms (>700 sqft)					
• Purpose-built kindergarten room (>800 sqft)	26	x	2	=	52
• Kindergarten room >700 sqft	23	x	1	=	23
• Regular classroom	23	x	11	=	253
• Special education class	9	x	1	=	9
• Specialty withdrawal space (1 per school)	0	x	1	=	0
• Child Care (exclusive use)	0	x	1	=	0
Classroom subtotal			17		
Resource Room (>400 but <700 sqft)	12	x	1	=	12
<b>Total</b>					<b>349</b>

# PART preferred JK to Grade 6 option

- Transitions
  - Aligns with transition of other schools into Alexander Muir/Gladstone
    - All other feeder schools enter for grade 7
  - Recent pathway decisions/program choices of students graduating from Givins/Shaw
    - Late Entry (grade 7) Extended French and Alternative schools
- Likely Potential for Portables
  - Location options on the Givins/Shaw site
  - TDSB perspective on the use of portables
    - Roughly a quarter of TDSB elementary schools have one or more portables on site
    - Long-Term Program and Accommodation Strategy (LTPAS) driver:
      - “Minimal Use of Portables - Minimize the use of portables (three is acceptable if space allows)”

# Opportunity for Feedback

1. QR Code:



2. Online survey link: <https://goo.gl/forms/AwXY94CvFROxLTsy2>
  - Deadline to submit online comments/feedback: **Friday, May 11, 2018 at 5:00pm**
3. Hard copy Community Feedback Surveys are available here

The Information provided at this meeting will be available on the TDSB website:

[www.tdsb.on.ca/accommodationreviews](http://www.tdsb.on.ca/accommodationreviews)

- Click on Givins/Shaw Jr PS under the “Program Area Reviews” Section

## Next Steps

Program Area Review Team (PART) to review and consider feedback from this evening.

- Next working meeting: **May 15, 2018**

Program Area Review Team (PART) to develop a set of recommendations and a report.

Program Area Review Team (PART) submits report summarizing recommendations to Central Accommodation Team (CAT).

Prior to the Board meeting, there will be opportunity for public to depute at the Planning & Priorities Committee.

- Target Date: ~~June 13, 2018~~ **Revised: June 4, 2018**

Recommendation are considered by the Board of Trustees at the Regular Board meeting for final decision

- Target Date: **June 20, 2018**

# Planning and Priorities Committee Meeting

In addition to the feedback provided today there is also the opportunity to make a delegation to the:

Planning & Priorities Committee – ~~June 13, 2018~~ **Revised: June 4, 2018**

Members of the public can make a delegation to this Committee.  
(Instructions and Forms are available here tonight)

More information about the process can be found by the sign-in sheets.

Please ensure that you have included an email address with the sign-in sheet so that we can continue to follow up with you as more information becomes available.



# Questions





Toronto  
District  
School  
Board

Givins/Shaw Jr. PS  
 Room Uses and Capacity  
 July 2017

Capacity (pupil places):  
 First floor = 144  
 Second Floor = 205  
 Total = 349

Revised capacity from 329 to 349 as room 6/7 was divided into two classrooms (-26+23+23).

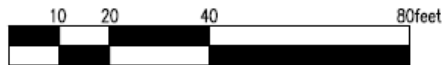

Wall was installed to separate Rooms 6 and 7 into 2 classrooms. Both are to be used for FDK in 2016/17 but Room 7 does not have W/R.

- Legend:
- Kindergarten 900+ sq ft
  - Kindergarten 800-900 sq ft
  - Regular Classroom 700+ sq ft
  - Special Education Classroom
  - Specialty Classroom
  - Resource Room 400-700 sq ft
  - Seminar Room <400 sq ft
  - Section 23
  - PFLC
  - Child Care Exclusive Use
  - Child Care Shared Use
  - Room Loading
  - 2016/17 Room Use

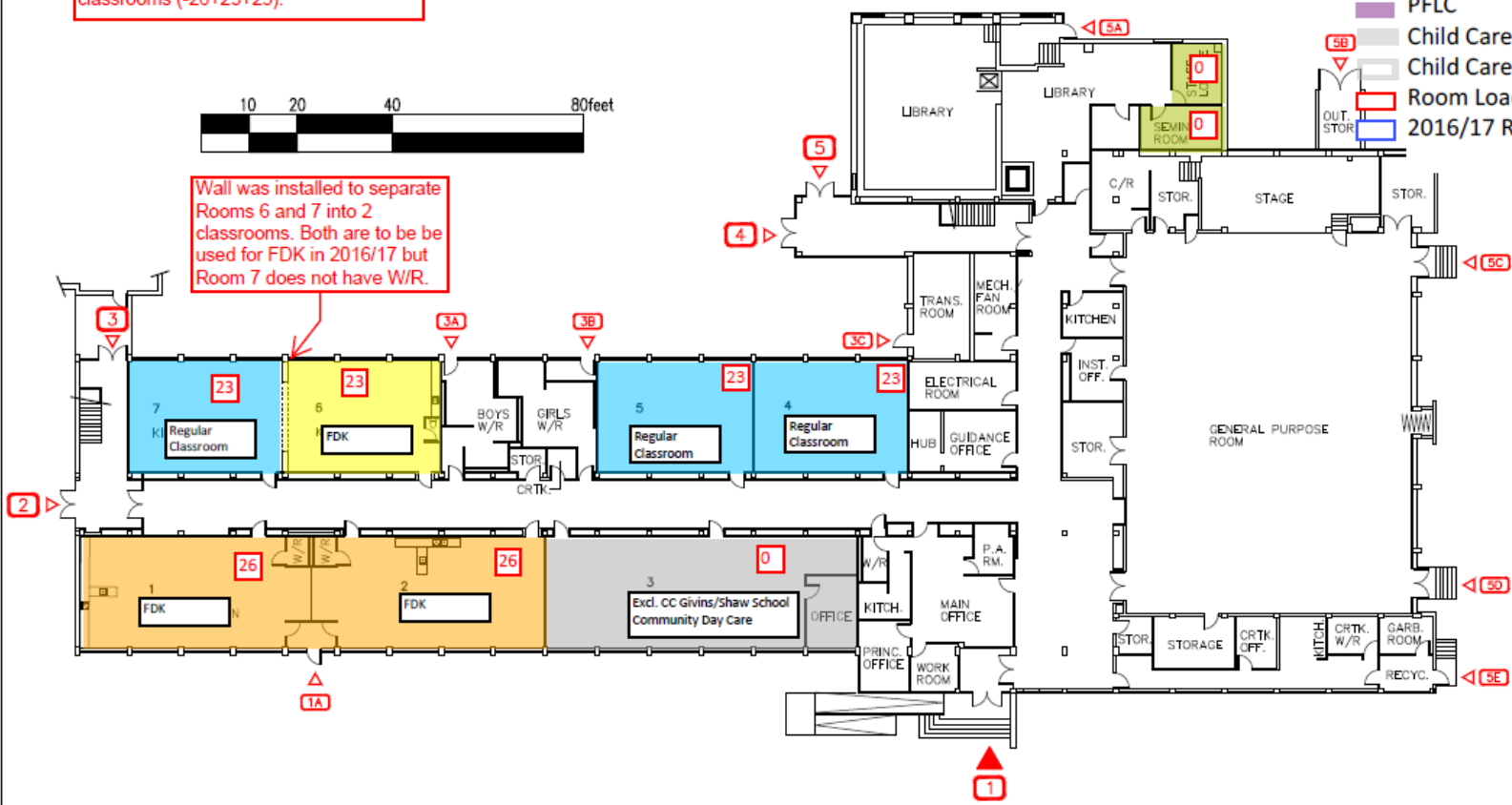

North Arrow

Facility Services

**Toronto District School Board**

Technical Services Division  
 Design & Construction Unit  
 15 Oakdown Court, Toronto, Ontario M2N 1T5  
 T: 416-395-4083 F: 416-395-9734

Facility  
**Givins/Shaw Jr. PS**

Address  
 49 Givins Street  
 Toronto

Sheet Title  
 1st. Floor

Facility # 0772	Last Update 15-07-16
--------------------	-------------------------

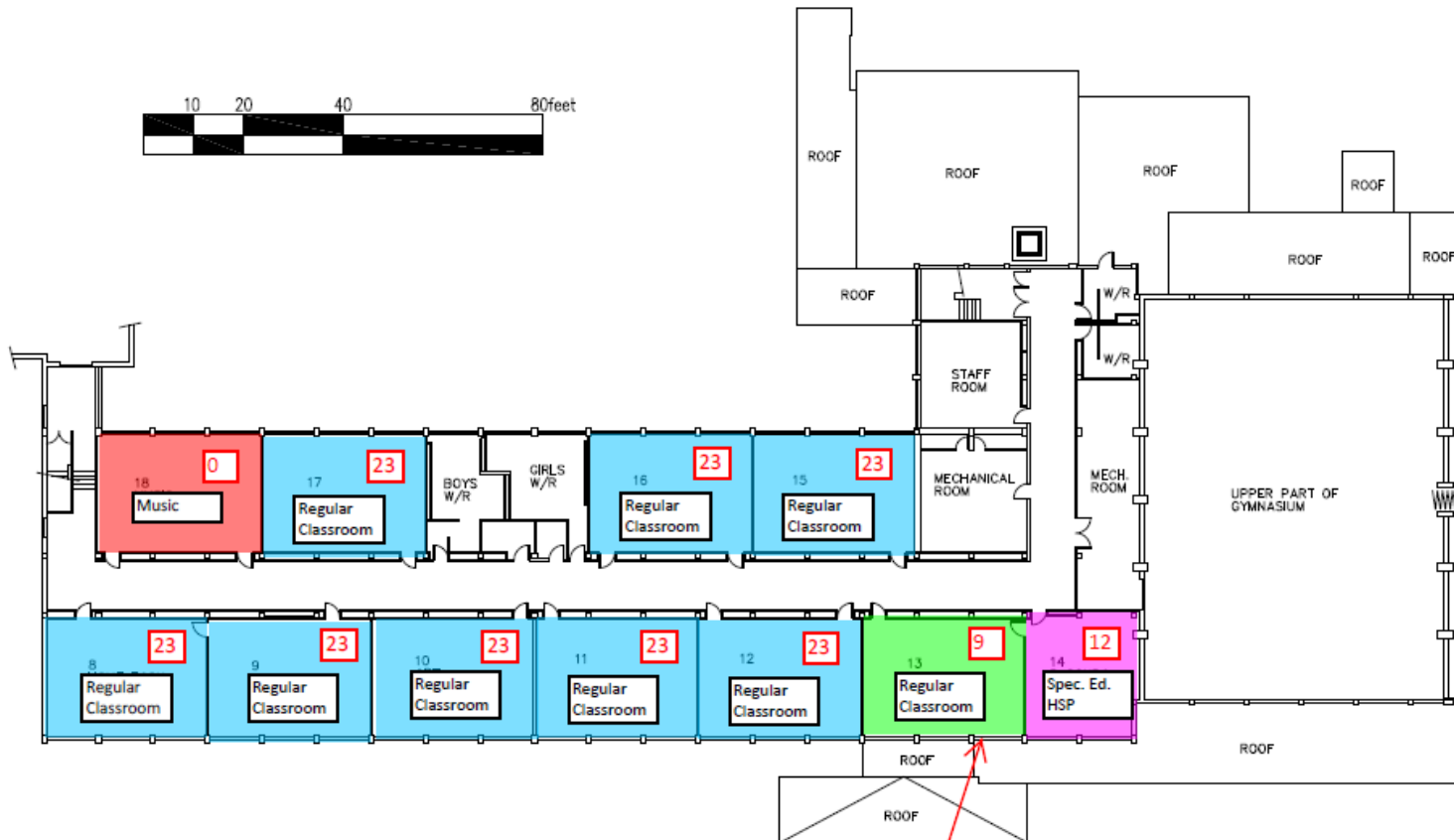

Loaded at 9 in lieu of HSP running in resource-sized space (room 14)

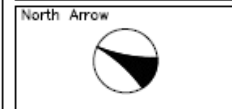

Facility Services

Toronto District School Board

Technical Services Division  
Design & Construction Unit  
15 Oakburn Cres. Toronto, Ontario M2N 2T5  
L 416-395-4588 / T 416-395-9734

Facility  
**Glvins/Shaw Jr. PS**

Address  
49 Glvins Street  
M6J2X5  
Toronto

Sheet Title  
2nd Floor

Facility # 0772	Last Update 09-10-30
--------------------	-------------------------