



# Bedford Park public school

Respect, Responsibility, & Safety  
is #1 at Bedford.

*Le respect, la responsabilité, et  
la sécurité est la priorité à Bedford.*

Main Office: 416-393-9424

Stay connected by checking our website often at  
[school.tdsb.on.ca/bedfordpark](http://school.tdsb.on.ca/bedfordpark) and  
follow us on Twitter @BedfordParkPSTO

Principal | Directrice: Mme Susan Pitre  
Vice-Principal | Directrice-Adjointe: Ms. Melissa Berger

Office Administrator: Ms. Judy Cook  
Office Secretary: Ms. Esther Ching

Interim Director of Education: Dr. Carlene Jackson  
Superintendent: Mr. John Chasty  
Trustee: Ms. Rachel Chernos Lin

[15 September 2020]

[Issue #1] :: The Bedford Blues eNewsletter



## Inside

- School Council Corner..... ②
- Meet the Staff ..... ④
- Our Commitment..... ⑤
- Communication..... ⑤
- Staggered Start Dates..... ⑤
- New Practices..... ⑥
- IXL..... ⑦
- Entry/Dismissal Areas..... ⑧
- Recess Zones..... ⑨
- Timetables..... ⑨
- About our eNewsletter ..... ⑩
- Anaphylaxis ..... ⑩
- Secure Access Systems..... ⑩
- How Useful is Homework?..... ⑩
- September 2020 Calendar. ① ①

## Principal Message

Welcome Back! Bonne rentrée!

These have been extraordinary times, and we've not experienced anything like them before. We are in for a school year like no other we have ever experienced. Nothing has prepared us for this. We must prepare for a new way to be in and out of the school. The school we left in March is not the school we are returning to in September.

We know that you will have many questions. We hope that this publication of the brand new monthly "Bedford Blues" eNewsletter will help you get to know some of the health and safety measures put in place to keep our students and staff safe. We must move forward together. We need everyone on board! Thank you for doing your part.

The Bedford Staff have been working hard to plan lessons to prioritize students' mental health and well-being needs, making students feel comfortable with the transition as they return to the classroom. Working with kindness and caring, we recognize in ourselves and others that we are all doing the best we can and some days will be better than others.

A great deal of time, effort, and thought has gone into the process of student placements for the 2020-21 school year. Thank you for being positive with your child and helping him/her understand that our staff works hard to make school a positive experience for ALL students. Your commitment to ensuring that Bedford remains a celebrated and successful school is awe-inspiring! Together, we will make this school year one of positive growth and achievement for all students.

Your partners in education,  
Mme Susan Pitre | Principal | Directrice  
Ms. Melissa Berger | Vice-Principal | Directrice-Adjointe

## Welcome back Bedford Park! A new school year like no other...

Bedford Park Parent Council would like to extend a warm welcome back to all our Bedford families. We hope you and your family had a relaxing and fulfilling summer break and that all your loved ones remained safe and well.

Please join us in a BIG WELCOME to our new principal SUSAN PITRE. A challenging time to start at a new school but she is eager, organized and prepared and we know the community will welcome her with open arms.



### COVID-19 UPDATE:

We have had the pleasure of supporting Mrs. Pitre and Mrs. Berger over the summer with the Safe Return to School program and the administration has been working hard on behalf of our children to ensure all the right measures are in place within the Board restrictions.

We understand that parents have lots of concerns regarding the safety, policies, and protocols in place. Parent Council Executive did agree to use available funds to fund numerous recommendations, such as portable air filtration units, hand washing stations, etc. However, at present, the Board is not allowing these purchases by Parent Councils we are awaiting confirmation as to the types of items we are allowed to fund. We have also been participating over the summer in the ward forums conducted by Rachel Chernos-Lin to stay abreast of what is happening in our ward and, as per the Parent Concerned Protocol, went to the Trustee and Superintendent to get resolution where appropriate.

### ***Immediate need for Volunteers to Support COVID safety measures***

Parent Council has committed to supporting the new morning protocols for drop off as detailed by the admin. We are looking for **4 parent volunteers each morning from 8:20am to 9am**. The volunteers will be stationed at each entrance and their duty is to remind students and parents that masks are MANDATORY on property before entering school in the am and to direct children to their appropriate place to meet their teacher. This is important given we don't have a staggered start and all children could be entering the school at the same time. Please email us at [BedfordparkPC@gmail.com](mailto:BedfordparkPC@gmail.com) with the subject VOLUNTEER and your availability. Parents are required to have their Toronto Police Criminal Reference Check in order to volunteer.

### **COMMUNICATION AND COMMUNITY!! Important Bedford Park PS Website has CHANGED:**

<https://schoolweb.tdsb.on.ca/BedfordPark>

As Principal Pitre communicated in the spring, we have a new website! All communication updates from the School and Parent council will be posted on the school's website as the primary source of info and communication. We recommend that you bookmark the link so that you can get the latest news and calendars. The website is evolving and being updated. The calendar on the website is a live google calendar which parents and students can access. You will not receive a weekly Bedford Blues newsletter. Bedford Blues will now be a monthly newsletter and a copy will be emailed and posted to the website.

School  
Council  
Corner



### ***For those who are electing Virtual School...***

Although you may not be lining up your classmates on the first day back, each Bedford child is a part of our community. If you wish to stay up to date with everything that is happening at the school, your first port-of-call will be the school website. If you have any specific questions, please reach out via the parent council email [BedfordparkPC@gmail.com](mailto:BedfordparkPC@gmail.com). One of our parent volunteers will be working hard to ensure that as a Bedford family you stay engaged and connected to the Bedford community. Watch the website for an opportunity to register on our Remote Learning communication list.

### ***Upcoming Virtual Parent Council Meetings;***

This year, we plan to host virtual parent council meetings and invite both in-class and remote families to attend. The meetings will cover parent council issues and a town hall forum with the administration. More details to follow, look for info on the website the week before the first meeting.

**October 20, 6:30-7:30pm**

**November 17**

**December 8**

### **PARENT COUNCIL BACK TO SCHOOL TIPS: *What to Pack?***

We recommend that each child bring in their own hip sack or little bag with the following personally labelled items:

- A few spare face masks
- Small hand soap and/or hand sanitizer
- Weather appropriate clothing as they may be outside more
- In addition, please ensure your child has their own school supplies, pencils, erasers, pencil crayons, pencil sharpener, ruler. Once teachers have been assigned, they will contact you directly to advise of any additional school supplies required as no sharing of pencils etc. can take place.

### **IN CLOSING...**

If you have any ideas you would like to share, concerns or you would like to help in any way, please contact the Parent council at [BedfordparkPC@gmail.com](mailto:BedfordparkPC@gmail.com). We know our community is full of talented people with amazing ideas, every contribution is appreciated.



# Bedford Park

## Public School



# Introducing

## the 2020-21 Bedford Staff!

Mme Pitre Ms. Berger	Principal Vice-Principal		Ms. Cook Ms. Ching	Office Administrator Office Secretary
Ms. Sekiomoto Ms. Mark Ms. Hunter Ms. Callahan	FDK A FDK B FDK C FDK D	Room 9 Room 7 Room 5 Room 3	Ms. Hsu Ms. Simpkins Ms. Srikantha Ms. Gillis	ECE ECE ECE ECE
Ms. Balogh Ms. Penate Ms. Gryfe Ms. Mitz Mr. Grant Ms. Burk Ms. Nelson Ms. Komlos Ms. Yip	Gr 1 A Gr 1 B Gr 1   2 A Gr 2 A Gr 2 B Gr 2 C Gr 3 A Gr 3 B Gr 3 C	Room 10A Room 13B Room 11 Room 28 Room 10 Room 6 Room 26 Room 25 Room 27	Mme Webb Ms. Corner Ms. Diakos Ms. Abamoussa Mr. Pimentel Ms. Nadel Mr. Ianni Ms. Ludin Ms. Rix Ms. Haque   Mr. Carmona Ms. Brownlee Mr. Norris Ms. Kim Ms. Malouin To be announced	Gr 4 EF Gr 4 A Gr 4   5 Gr 5 A Gr 5   6 A Gr 5   6 B Gr 6 A Gr 7 A Gr 7 B Gr 7 C Gr 8 A Gr 8 B Gr 8 C Gr 6-8 ISP Child & Youth Worker
Ms. Noer Ms. Henry Mr. Carmona Ms. Yasny Ms. Micheff Mr. Lukas Mr. Coady Mr. Henneberry Ms. Lavender	HSP Resource + Prep ESL (AM) ESL + Prep FSL + Prep FSL + Prep Music Phys Ed Pool Instructor	Room 23 Room 23 Room B2 Room B4 Library Room 22 Gym Pool	Caretaking Team Mr. Beich Mr. Goodwin	Room 2 Room 14 Room 15 Room 18 Room B1 Room B8 Room 20 Room 28C Room 17 Room 16 Room 29 Room 30 Room 19 Room B3
Support Staff Ms. Barbieri Ms. Kushtova Ms. Sullivan	Educational Assistant Educational Assistant (PM) Special Needs Assistant		Lunch Room Supervisors Ms. Hynes Ms. Bandula Ms. Rehl Ms. Holmes	Ms. Murano Ms. Ratnam Ms. Radonicich Ms. Mazan

## SCHOOL RE-ORGANIZATION

In order to program effectively, it is essential that classes are well balanced and meet the Ministry of Education's mandated cap. At the beginning of September, the TDSB has alerted us where there was a need to balance the classes. At best, this is a difficult process as we re-organized. We have thoughtfully considered the strengths of all students in terms of their social, emotional, and academic growth. There will be no further changes to classroom placements.

# Our Commitment to Indigenous Education, Anti-Racism, and Anti-Oppression



WE are committed to providing equitable access to learning opportunities for all students. This includes our ongoing commitment to human rights, equity, anti-racism, anti-Indigenous racism, anti-Black racism, antioppression, and ALL other forms of racism and discrimination. (TDSB Vision for Learning)

This commitment will be the basis of everything we do at Bedford Park and underpins all programming at every grade level. We recognize that the intersections of social identities of students within our school adds further dimensions and complexities; therefore, we must ensure that we are cognizant of the role implicit bias plays and how it can impact students in negative and discriminatory ways in classrooms and schools. "We will effectively integrate the voices, choices, abilities, and experiences of our students into our school programming [and] be more responsive to the strengths, interests, gifts, and lived realities of our students as we create and design our schools and classrooms." (TDSB Multi-Year Strategic Plan)

## Communication @ Bedford

Stay connected with all of the communication from Bedford.

Here are the main modes of communication:



The Bedford Park Website: [schoolweb.tdsb.on.ca/bedfordpark](https://schoolweb.tdsb.on.ca/bedfordpark) *Set this as a favourite!*



Twitter: [@bedfordparkpsto](https://twitter.com/bedfordparkpsto)



Email: We will be sending you information through our SchoolMessenger system. Be sure to check your settings to ensure you do not have us blocked!



## Staggered Start Dates

The date remains the same for each grade, even for combined classrooms.

The following dates for a staggered start have been directed by the TDSB. We greatly look forward to seeing everyone back!

Date	Grades
Tuesday, 15 Sept 2020	SK, Grade 4, Grade 8, Ms. Malouin's class
Wednesday, 16 Sept 2020	Everyone from Tuesday + JK, Grade 1, Grade 7
Thursday, 17 Sept 2020	Everyone from Tuesday, Wednesday, + Grades 2, 3, 5, 6



# New TDSB COVID-19 Practices

Please review carefully.

**NEW**

Thank you for reviewing these practices with your child(ren) prior to the first day of school.

This section is an extension of the TDSB's publication "[Operational Guidelines – Elementary](#)" as we add detail specific to Bedford Park while under COVID-19 restrictions.

Toronto Public Health reminds us to stay at home when we are not feeling well. It is important for every family to do their part for the health and safety of students and staff.

To help with the morning routine, the TDSB has generated a "[Daily Checklist for Elementary School](#)"!

It is very important that you establish a routine with your child(ren) to arrive at school on time: backpack ready with all materials, 2 masks, boomerang lunch and snacks (garbage will be taken home), and water bottle filled with water. Arriving on time to school sets everyone up for success with a positive mindset.

Every entry door will have a screening station with a symptom poster, a bottle of hand sanitizer, and a Bedford Staff member who will complete a screening assessment prior to every student's entry.

Students arriving late will enter using the main doors and will receive a late slip from the incredible office staff. Depending on the age of the student, a staff member will walk the students to their classrooms. See the TDSB's "[Safe Return to School and Work Daily Health Screening](#)" page to review the paper pass and the **health screening app** for daily screening. We strongly encourage you to download the app for efficiency in the morning!

Very often parents will drop-off lunches or items students have forgotten at home. This is going to be strongly discouraged. We are limiting hallway traffic as well as the number of people entering the building. Please try your very best to send your child to school with everything that is needed for the entire day. A drop-off table will be put in the stairwell of the main entrance where you will be asked to leave any items you absolutely have to drop off. Office staff will not be calling students down to pick up the items.

When a student needs to be picked up early, please send a note or an email to the teacher and the office staff. The student will wait for you in the main office.



Everyone entering the main office is required to wear a mask. Please see the TDSB website for "[Mask and Face Covering Requirements](#)" for staff, students, and visitors.

Teachers will establish a handwashing routine with your child for every entry to the classroom as well as before eating snacks and lunch. Classrooms with washrooms will be used by that class. Washrooms in the hallways will have a reduced number of stalls to be used. The capacity limit will be posted outside the washroom.

For right now, hooks and lockers will not be used. Students will use the back of their chair to hang coats and backpacks. Classroom teachers will establish a space where boots may be kept and accessed while doing our best to maintain social distancing.

Students are to come to school with their water bottles filled. While we await the arrival of our water bottle filling station, some of our water fountains will be open for water bottle filling only. Posters will be set up over the fountain for filling water bottles only.

It is highly recommended by TDSB that students remain at school for lunch. Should they be going offsite, they are to go directly home to eat and return at the 12:20 pm bell for entry.



# New TDSB COVID-19 Practices

## *Continued*

Snacks and lunches are to be “grab-and-go”. All garbage will be taken home. Utensils will not be shared or provided. All food will be eaten in the classroom and lunch eaten the regularly scheduled lunch period (see page 8).

Special food days are on hold (e.g., Pizza Lunch).

Food deliveries will not be accepted (e.g., homemade lunch, Uber Eats, Skip the Dishes, DoorDash).

Students may bring their own technology to school with the knowledge that any device lost, stolen, or damaged is not the responsibility of Bedford Park PS.

Unfortunately, the pool will be closed until further notice.

When you are trying to connect with your child’s teachers, please use email to establish a date and time when you can speak over the phone call or set up a virtual meeting (e.g., Google Meet or Zoom).

When students and staff feel unwell throughout the school day, we have a comfortable space for them to remain safe and supervised. The Wellness Room will include all PPE (gown, shield, masks, and alcohol-based sanitizer). After each use, this room will be disinfected. Parents will be contacted immediately by Bedford office staff. If the first two contacts cannot be reached, we will move to your emergency contacts. It is very important that all of your contact information be up-to-date as well as current emergency contacts.

Each teacher will maintain a Google Classroom or Brightspace platform where assignments and information are shared with parents. Depending on the grade level, assignments may be submitted this way as well. This is NOT a replacement for in-class learning. Students who are away for a couple of days can look to Google Classroom or Brightspace to see some of the work that was missed; however, it will not have all the learning and/or assignments that happened in the classroom on any given day. Most of our students are familiar with how to use Google Classroom after our distance learning from April to June. Your child’s teacher will let you know what their preferred means of communication will be.

Thank you for helping everyone stay safe by following these new practices.



*IXL is an online personalized learning tool with a comprehensive math and English curriculum for JK to Grade 12. Gain fluency and confidence in math and English! IXL helps students master essential skills at their own pace through fun and interactive questions, built in support, and motivating awards. IXL's skills are aligned to the Ontario Curriculum, providing comprehensive coverage of math concepts and applications. With IXL's provincial curriculum alignments, you can easily find unlimited practice questions specifically tailored to each learning objective.*

### **Math & English Practice at home with IXL**

For those families who are interested in signing up with IXL ([www.ixl.com](http://www.ixl.com)) for additional grade-specific math and English problems to work on at home, please contact Natasha Ryde ([nryde@hotmail.com](mailto:nryde@hotmail.com)) by Friday October 9th. This year we are getting the math & English licence (not math-only, nor English-only). The cost is dependent on the number of students registered. Price will be between \$15.75/child to \$20/child for 12 months of access to this website, beginning in early November (NB: that this ‘class’ rate is substantially reduced from their ‘family’ rate of \$190/family). I will send out information on final cost at the end of October when we know how many students register. I will send payment information at that time. ~ Natasha Ryde, Bedford Parent

# Entry/Dismissal Areas

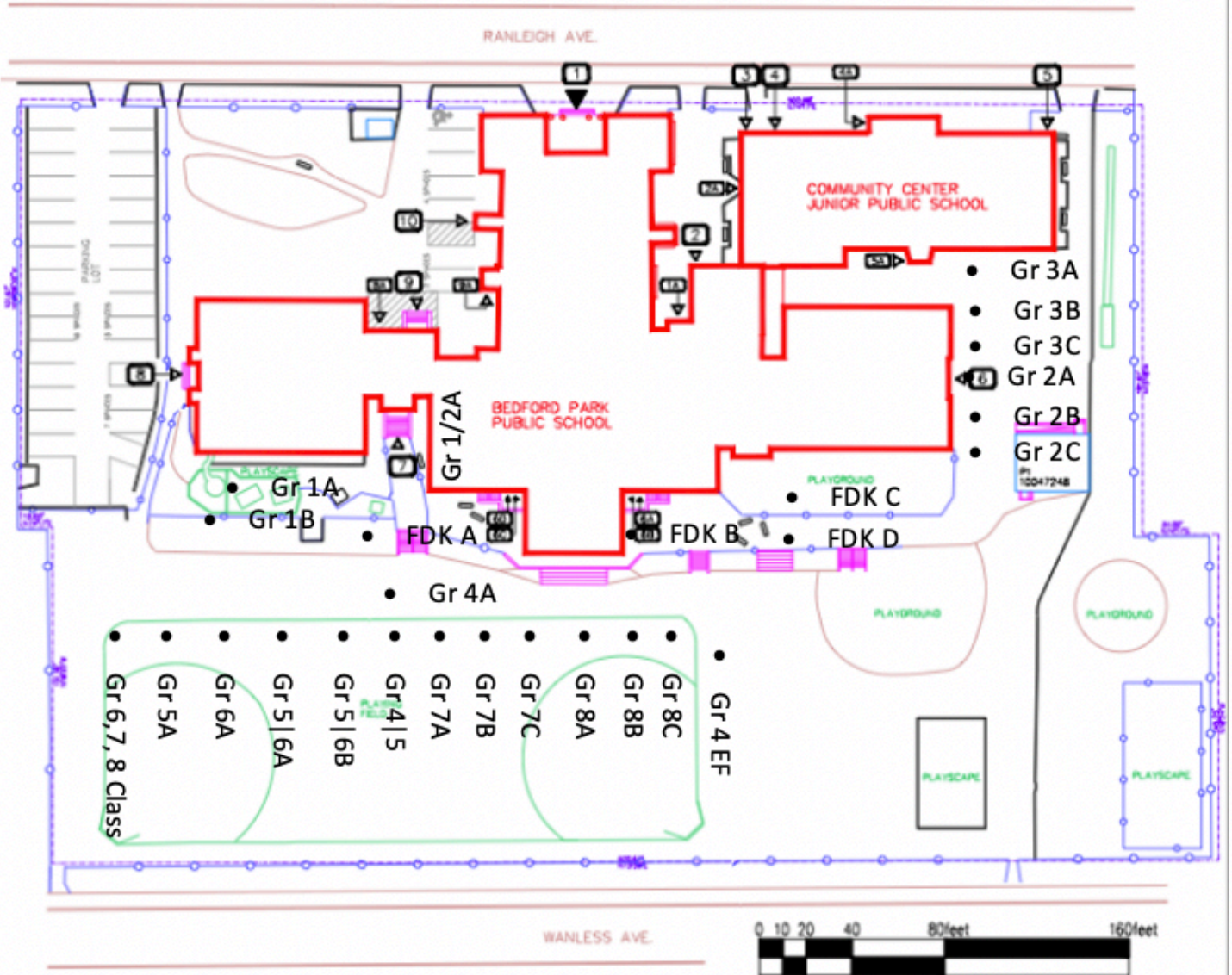

Grade	Entry/Dismissal Door	Location Details
<p><i>Parents are reminded to wait on the lower pavement/track.</i></p> <p><i>Please do not go up to the upper pavement due to space limitation.</i></p> <p><b><i>Parents wishing to come onto the premises are asked to wear a mask as social distancing will be a challenge.</i></b></p>		
Ranleigh Rascals	Exit 2	Only to be used by Ranleigh Rascals' pre-school children
FDK A	Centre Door – Exit 6C	Students will line up at the classroom door.
FDK B	Center Door – Exit 6A	Students will line up at the classroom door.
FDK C + D	Centre Door – Exit 7	Students will line up near the upper playground
Grades 1A, 1B, 1 2	Centre Door – Exit 7	Students will line up against the school along the path
Grades 2 - 3	East Door – Exit 6	Students will line up outside the exit door 6
Gr 4, 4EF, 4 5	Centre Door – Exit 7	Students will line up along the track or soccer pitch
All Grades 5 – 8	West Door – Exit 8	Students will line up on the soccer pitch facing the school



# Outdoor Zones @ Bedford

New!!

Students will engage in play in a specific zone during outdoor times.

Teachers will work with students as part of their first day exploration to understand the new way of playing outdoors.

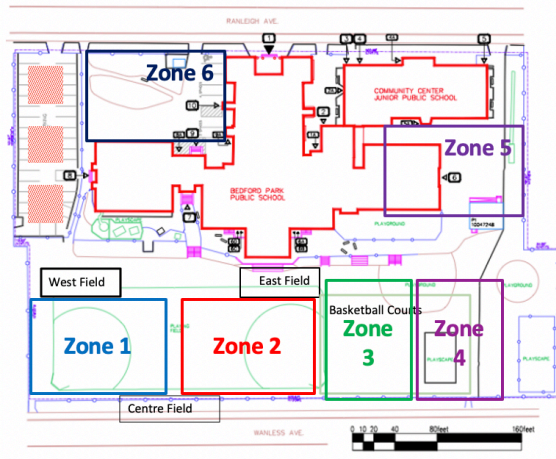

Recess	Zone 1	Zone 2	Zone 3	Zone 4	Zone 5	Zone 6
Group A	Mme Webb Ms. Yip	Ms. Burk Ms. Balogh	Ms. Gryfe Ms. Penate	Ms. Mitz Mr. Grant	Ms. Nelson Ms. Komlos	Ms. Corner Ms. Diakos
Group B	Ms. Brownlee Mr. Norris	Ms. Kim Ms. Haque Mr. Carmona Ms. Malouin	Mr. Ludin Ms. Rix	Mr. Ianni Ms. Abamoussa		Mr. Pimentel Ms. Nadel

*Playscape may be used for single class use of recess time.*  
Entry for washroom during recess time will be Exit 8.

## Timetable for 2 Groups

Group A			Group B		
Time	Length	Period   Recess	Time	Length	Period   Recess
8:45-8:50 am	5 min	Entry	8:45-8:50 am	5 min	Entry
8:50-9:20 am	30 min	Period 1	8:50-9:20 am	30 min	Period 1
9:20-10:00 am	40 min	Period 2	9:20-10:00 am	40 min	Period 2
10:00-10:15 am	15 min	Recess	10:00-10:40 am	40 min	Period 3
10:15-10:55 am	40 min	Period 3	10:40-10:55 am	15 min	Recess
10:55-11:35 am	40 min	Period 4	10:55-11:35 am	40 min	Period 4
11:35 am -12:25 pm	55 min	Lunch Inside: 11:35-11:55 Outside: 12:00-12:25	11:35 am -12:25 pm	55 min	Lunch Outside: 11:35-11:55 Inside: 12:00 - 12:25
12:25-12:30 pm	5 min	Entry	12:25-12:30 pm	5 min	Entry
12:30-1:10 pm	40 min	Period 5	12:30-1:10 pm	40 min	Period 5
1:10-1:25 pm	15 min	Recess	1:10-1:50 pm	40 min	Period 6
1:25-2:05 pm	40 min	Period 6	1:50-2:05 pm	15 min	Recess
2:05-2:45 pm	40 min	Period 7	2:05-2:45 pm	40 min	Period 7
2:45-3:15 pm	30 min	Period 8	2:45-3:15 pm	30 min	Period 8



## The Bedford Blues eNewsletter

A little news about the Bedford Blues eNewsletters

You are receiving this month's publication of "The Bedford eNewsletter" via email. All publications will be distributed using email and posted on the Bedford website. To ensure that you receive all information from the school and the TDSB, it is important that we be given your email address and your permission to communicate using your email.

Today, your child will get a small "Welcome" package as the TDSB has moved to digital forms! Please watch your email this coming week for the message with the "Permission Click" link and login information.

Let's stay connected!

## Secure Access Systems A Reminder to You



As per Operational Procedure PR663, we have a secure access system at our main entry that gives our Staff more control over who enters our school. The outside doors will be locked and a buzzer system is to be used to gain access to the front of the school. Using this system will provide a safe, welcoming environment, and a single point of entry where visitors will be directed to the office. Thank you! Merci!

## Anaphylaxis Taking the Necessary Precautions



Anaphylaxis is a serious allergic reaction that can be life threatening. This medical condition can cause a severe reaction to specific foods or other materials, and can result in death within minutes. Although foods such as peanuts, milk, eggs, and sesame seeds are the most common cause of anaphylaxis, insect stings, medicine, or latex can also cause a reaction. In recent years, anaphylaxis has increased dramatically among students. The TDSB is committed to maintaining a safe and healthy learning environment for all students and works with Toronto Public Health and other partners to ensure the successful implementation of Sabrina's Law, which came into effect on January 1, 2006.

Although this may not affect your child's class directly, we want to raise awareness about this life-threatening condition. Students who have severe allergies to such food substances are exposed to a severe health risk when such products are consumed in their environment or shared with them. As prevention is the best approach, we ask that you speak with your child about not sharing their snacks or lunches with other students and please do not send any snacks or lunches with your child that contain peanuts.

If your child has health problems of any kind, please inform your child's teacher or office staff immediately so that the necessary health protection steps may be taken and to ensure everyone's co-operation for a safe learning environment.

More information about life threatening allergies is available on the Anaphylaxis Canada's website at <http://www.anaphylaxis.org/> or by calling 416-785-5666.



## How Useful is Homework?

By: Ontario Institute for Studies in Education: 16 November 2010

Parents, children, and teachers have always argued about homework! Common questions include: Should teachers give homework to students? If so, how much and what type of homework should be assigned? How much time should students spend on homework? What roles should parents play in their child's homework?

Quite a bit of research has been done over the decades on homework, but researchers still hold divergent views on the subject.

The best current evidence is that homework seems to have a small positive influence on student achievement, though it may be that students with better grades just tend to do more homework. The evidence for a positive impact of homework on student achievement in the primary grades is weak, although some evidence suggests that homework may help students develop good study habits and foster positive attitudes toward school and learning.

Parents can also play an important role by supporting their children's learning at home, encouraging learning outside of school, and monitoring their children's progress regularly. It is important to be positive and encouraging when working with your children on homework; if homework leads to bad feelings between parents and children it can have negative effects on both school and home relationships.



Bedford public school

# September | septembre





2020

If your child will be late or absent, please email the school at [BedfordParkPS@tdsb.on.ca](mailto:BedfordParkPS@tdsb.on.ca) or call us at 416-393-9424.



## Characteristic of the Month:

*Respect | Le respect*

Sunday dimanche	Monday lundi	Tuesday mardi	Wednesday mercredi	Thursday jeudi	Friday vendredi	Saturday samedi
		1	2	3	4	5
6	 7	8	9	10	11	12
13	14	Day 1 	15 See page 4 for your start date!	16	17	19
20	Day 5 <b>DUE:</b> Medical and Consent Digital Forms	Day 1 22	Day 2 23	Day 3 24	Day 4 25 Journée du drapeau Franco-Ontariens 	26
27	Day 5 28	Day 1 29	Day 2 30 Orange Shirt Day 	Day 3 Oct 1	Day 4 Oct 2	28

**BUILD CHARACTER  
BUILD SUCCESS**

Next Characteristic of the Month:  
*Responsibility | La responsabilité*

### Some Upcoming October Dates:

05 October – World Teachers’ Day  
12 October – Thanksgiving Day, No School

07 October – Virtual Curriculum Night @ 6:30pm – 7:30 pm

Be sure to visit the live Google Calendar on the Bedford Park website!