

Eglinton Crosstown LRT Chaplin Station

Brittany Maxwell

Metrolinx Community Relations & Issues Specialist

METROLINX MANDATE

PLAN



BUILD



OPERATE



REGIONAL TRANSPORTATION PLAN

- Since 2008, Metrolinx has been guided by its Regional Transportation Plan which is a multi-modal, long range plan for the GTHA
- Developed in consultation with municipalities, residents and many stakeholders across the region.
- Provides strategic direction for planning, designing and building a regional transportation network that enhances:
 - our quality of life,
 - our environment, and
 - our prosperity
- Review for Next Regional Transportation Plan now underway

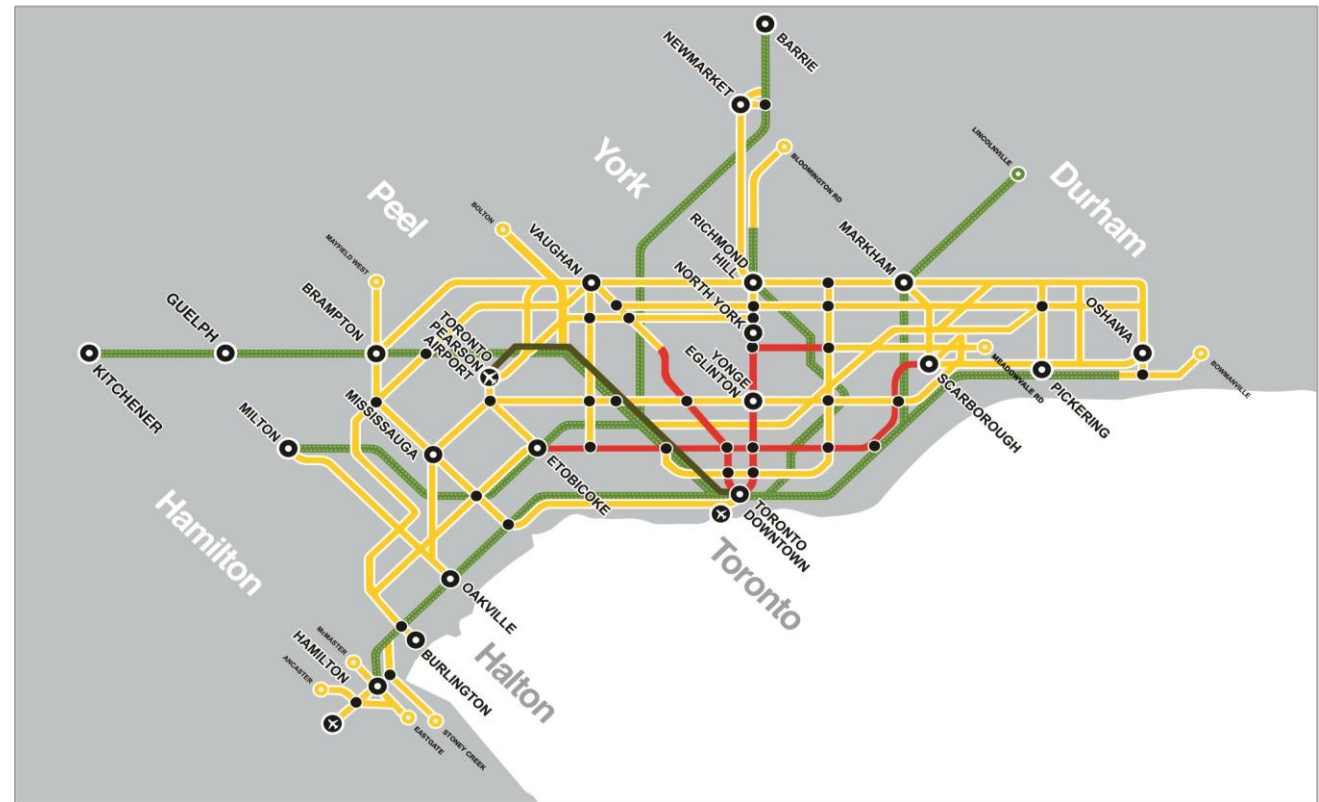

The Big Move proposes to build over 1,200 km of rapid transit – more than triple what existed in 2008 – so that over **80 per cent of residents** in the region will live within 2 km of rapid transit

OVER \$30B IN INVESTMENT IN THE GTHA'S RAPID TRANSIT NETWORK



EXPANDING GO TRAIN SERVICE

- More service on all lines
- Electric trains, every 15 minutes or better in both directions, for most GO customers
- 23 more stations and line extensions to serve new markets



77 KM OF NEW LIGHT RAIL TRANSIT

- Under construction:
- Eglinton Crosstown
- In procurement:
- Finch West
 - Hurontario
 - Hamilton
- In design / planning:
- Sheppard East



52 KM OF NEW BUS RAPID TRANSIT

- Partially in-service, with remainder under construction:
- Viva in York Region
 - Mississauga Transitway

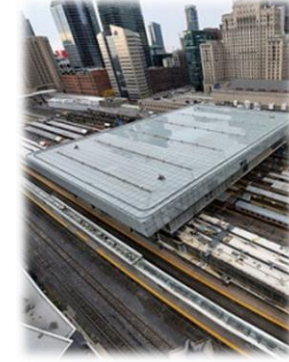

CONNECTING IT ALL TOGETHER

- Expanding and revitalizing Union Station, the heart of the regional network
- PRESTO now in use across the Region

EGLINTON CROSTOWN LRT

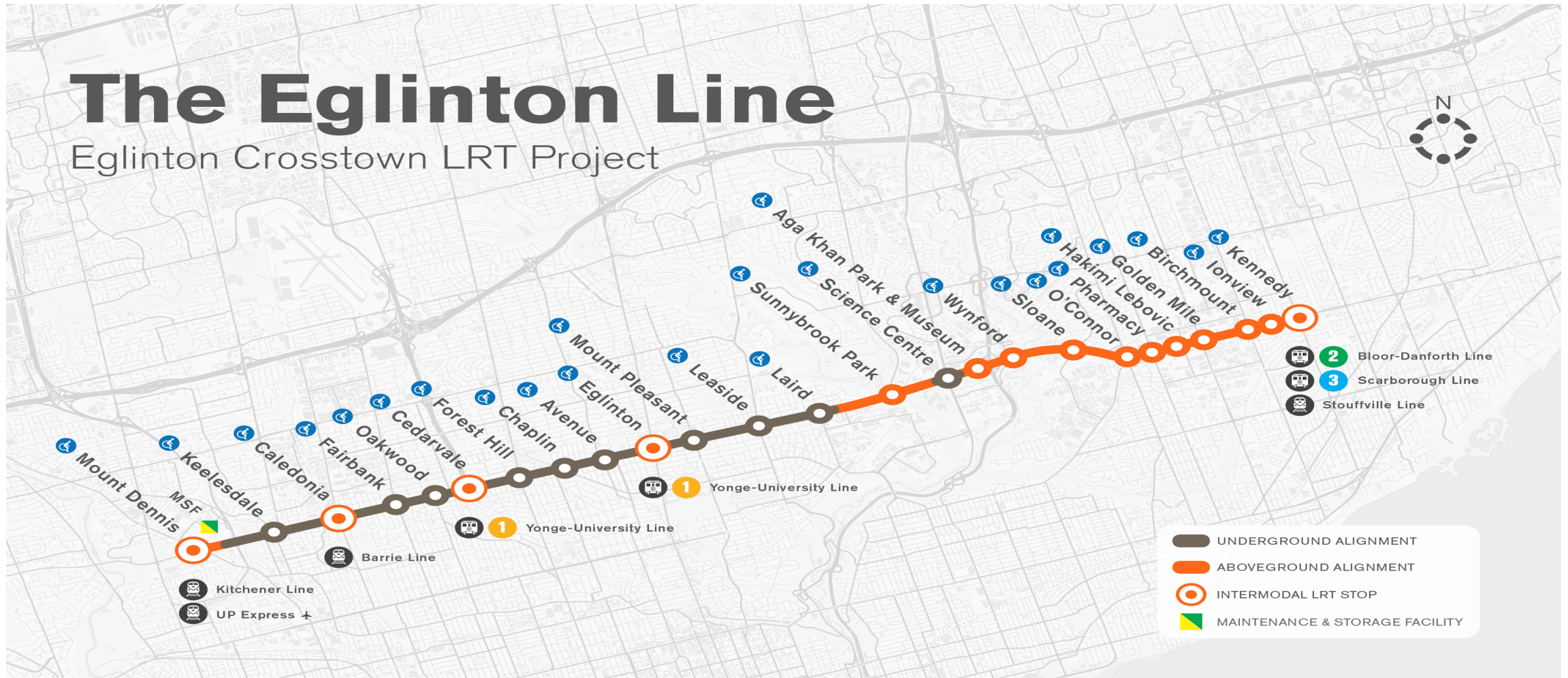

EGLINTON CROSSTOWN LRT



CHAPLIN STATION AERIAL VIEW



CHAPLIN STATION MAIN ENTRANCE PLAZA (NE CORNER OF CHAPLIN & EGLINTON)



CHAPLIN STATION SECONDARY ENTRANCE (BELTLINE TRAIL, SW CORNER OF CHAPLIN & EGLINTON)



CHAPLIN STATION TERTIARY ENTRANCE (OLD FIRE HALL, SE CORNER OF CHAPLIN & EGLINTON)



CHAPLIN STATION - CONSTRUCTION LOOK AHEAD

ACTIVITY	AREA	IMPACT	DURATION	START DATE
Support of Excavation - Piling	Within northwest work zone on Eglinton Ave W	<ul style="list-style-type: none"> Noise and vibration from drilling activity 	Ongoing through Winter 2018	Underway
Guidewall Removal	Within southeast work zone on Eglinton Ave W	<ul style="list-style-type: none"> Noise and vibration from concrete breaking activity 	Periodically through Winter 2018	Ongoing
Watermain Bypass	Within southwest work zone on Eglinton Ave W and Chaplin Cres	<ul style="list-style-type: none"> Noise from construction activity 	Ongoing through March 2018	Underway
Storm Sewer Installation	Within southwest work zone on Eglinton Ave W and Chaplin Cres	<ul style="list-style-type: none"> Noise from construction activity 	Ongoing through March 2018	Underway
Traffic Change - Temporary Driveway Closure	North work zone on Eglinton Ave W at 564 Eglinton Ave W	<ul style="list-style-type: none"> Temporary driveway closure Relocation parking to Tertiary Entrance 	One (1) month	As early as February 7, 2018
Traffic Change - Close Latimer	North side of Eglinton Ave	<ul style="list-style-type: none"> Extension of northeast work zone No access to Latimer Ave from Eglinton Ave W No access to Eglinton Ave W from Latimer Ave Shoppers Drug Mart southwest driveway closure 	Approximately one (1) month	As early as February 20, 2018

CHAPLIN STATION - CURRENT CONSTRUCTION STAGING IMPLEMENTED LATE JANUARY (APPROX. 1 MONTH)

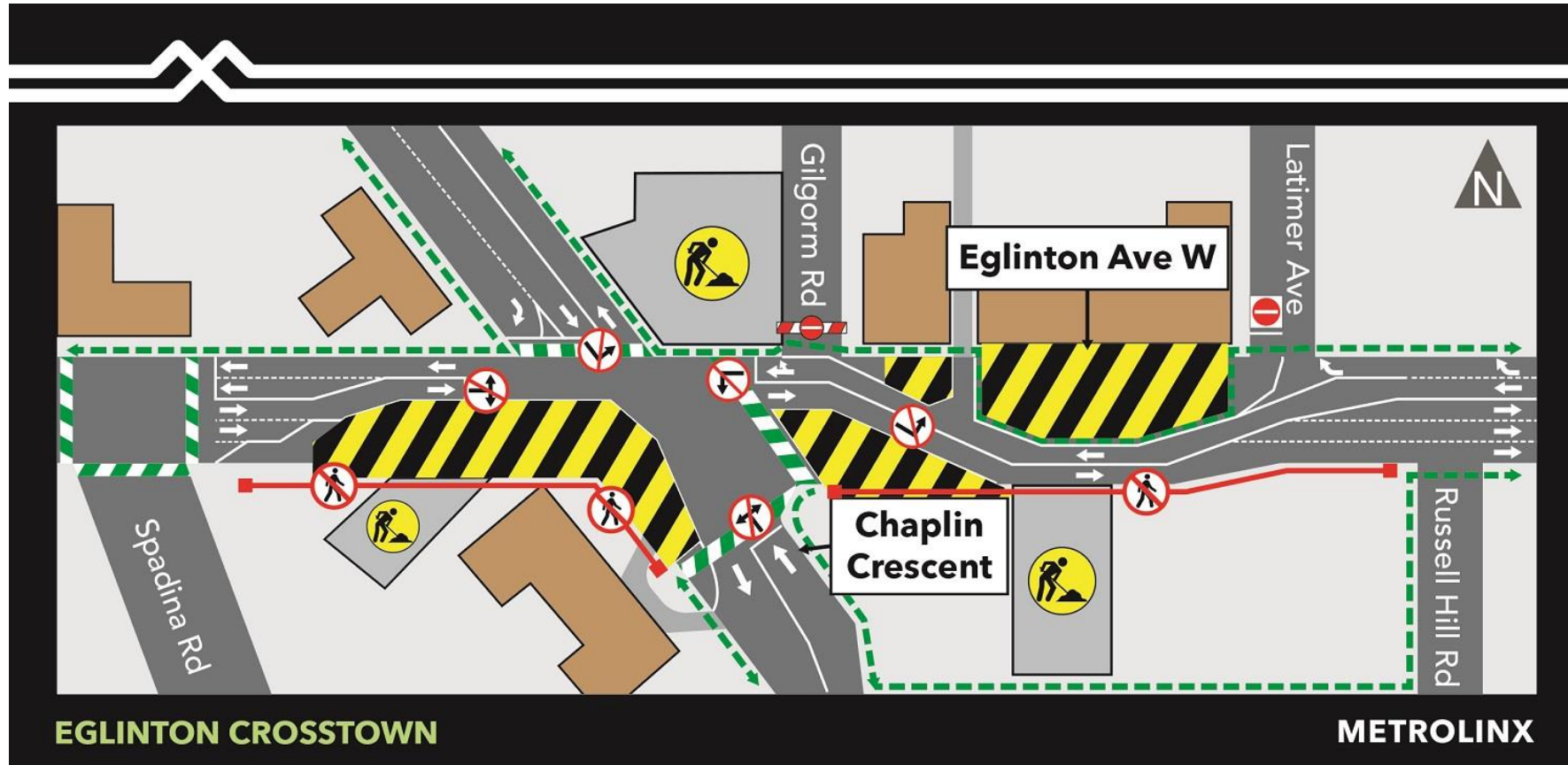

Activities: Support of Excavation, Utility Relocation, Sanitary Sewer Installation

CHAPLIN STATION - CURRENT CONSTRUCTION STAGING IMPLEMENTED LATE FEBRUARY (APPROX. 1 MONTH)

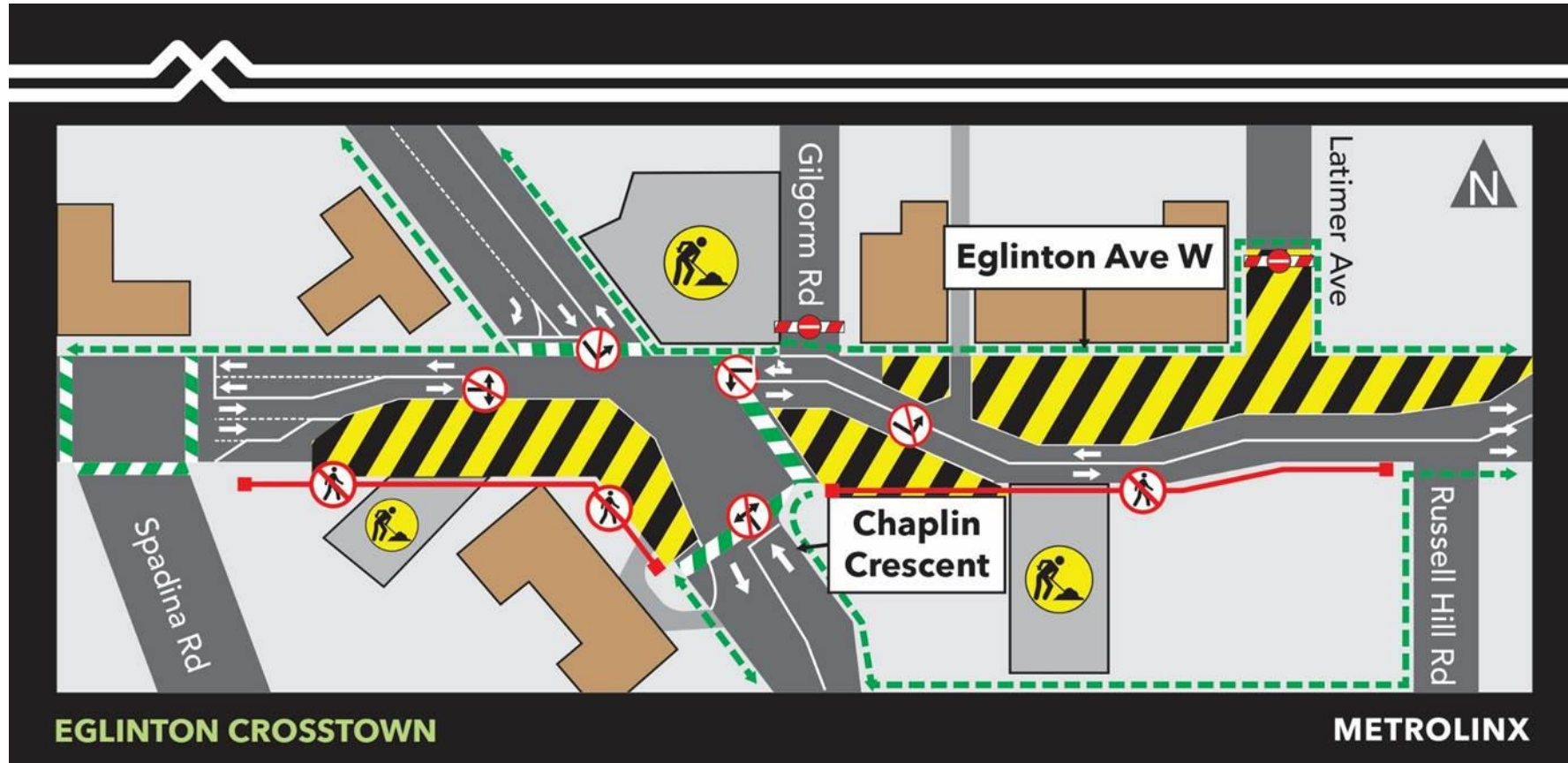

Activities: Support of Excavation, Utility Relocation, Sanitary Sewer Installation

CHAPLIN STATION - UPCOMING CONSTRUCTION STAGING *AS EARLY AS LATE MARCH 2018 (THROUGHOUT 2018)*

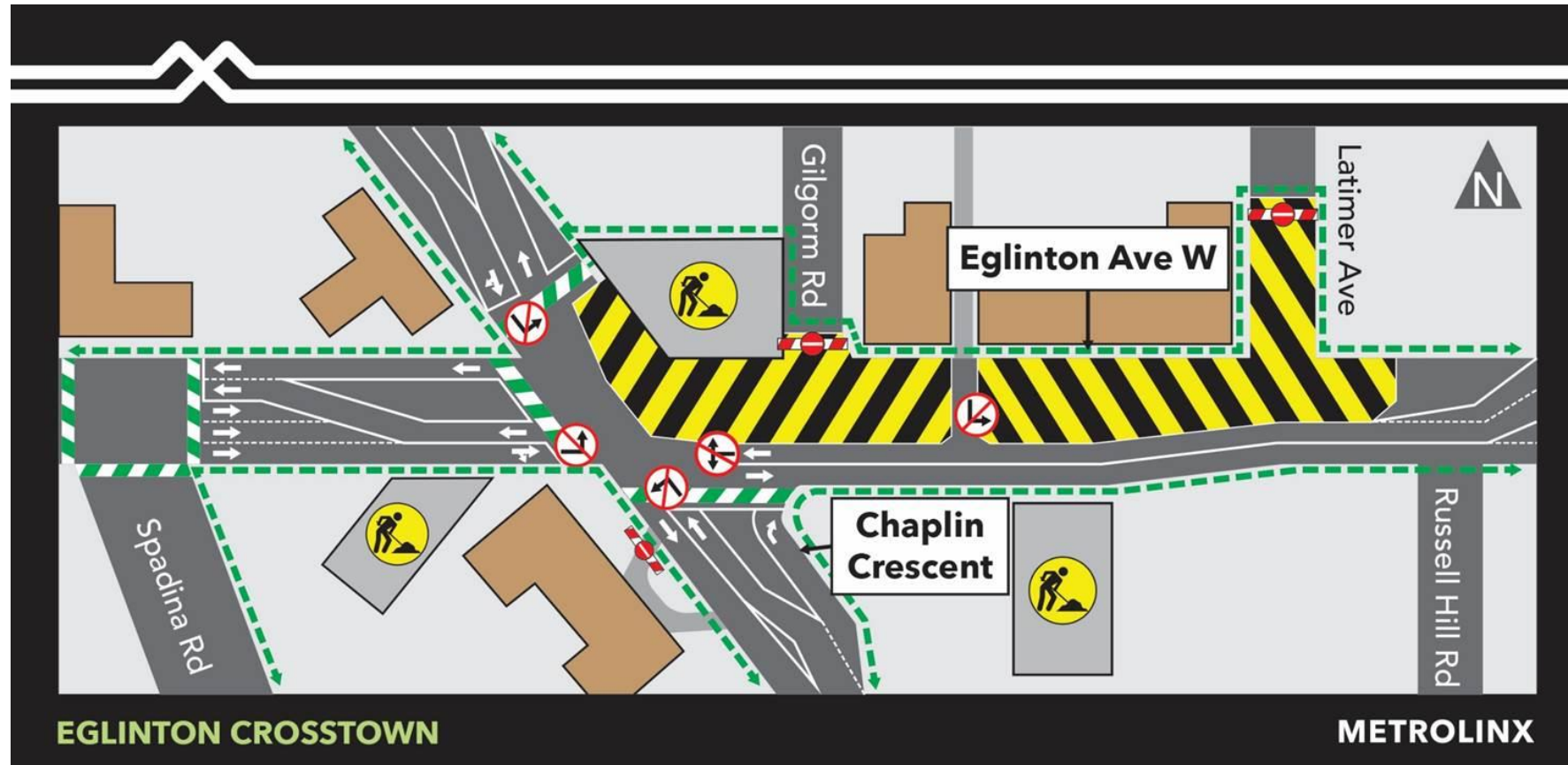

Activities: Support of Excavation, Utility Relocation, Sanitary Sewer Installation

QUESTIONS?



CONTACT US

Metrolinx West Crosstown Community Office

- 1848 Eglinton Avenue West (Dufferin & Eglinton)
- 24 Hour Phone Service: 416-782-8118
- Email: crosstown@metrolinx.com
- Website: thecrosstown.ca
- Email Newsletters: thecrosstown.ca/sign-up

